

*Perhaps your home has become too difficult and expensive to manage, your life has become a bit lonely, but you thought you couldn't afford a change. Have you considered Emanuel Village?*

At Emanuel Village you can experience secure, affordable living, enjoy the comfort and privacy of your own apartment, and meet new friends who share your interests.



### Each Apartment Offers...

- Individually controlled heat
- All utilities paid except cable TV and telephone
- Large closets
- Apartment-size refrigerator and stove
- Full bath with shower/tub combination
- Safety features in bathroom
- Emergency call cords in bathroom and bedroom
- Carpeting in living room and bedroom
- ADA compliant accessibility
- Eight handicapped accessible apartments

### The Emanuel Village Community Offers...

- The opportunity to meet new people, experience new activities
- Residents' laundry room with handicapped accessible washer/dryer
- Residents' community room with large screen TV
- Free convenient parking
- Access to public transportation
- A planned social calendar
- Nightly security checks
- 24-hour closed circuit security system
- 24-hour on-call emergency maintenance service
- On-site Resident Services Coordinator
- Outdoor grilling and picnic areas

### You May Reside at Emanuel Village if You....

- Are at least 62-years-old and/or mobility impaired
- Meet financial and other eligibility requirements established by the U.S. Department of Housing and Urban Development

### Room Plans...

Emanuel Village offers studio and one bedroom apartments designed to assure both efficiency and comfort. Emanuel Village is located in a quiet residential neighborhood in the Quinsigamond Village section of Worcester, behind Emanuel Lutheran Church.

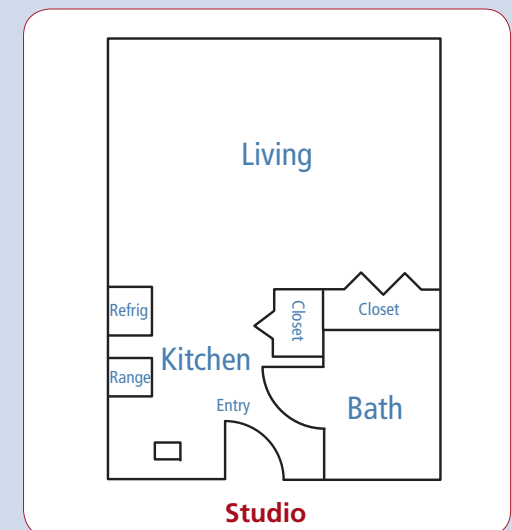
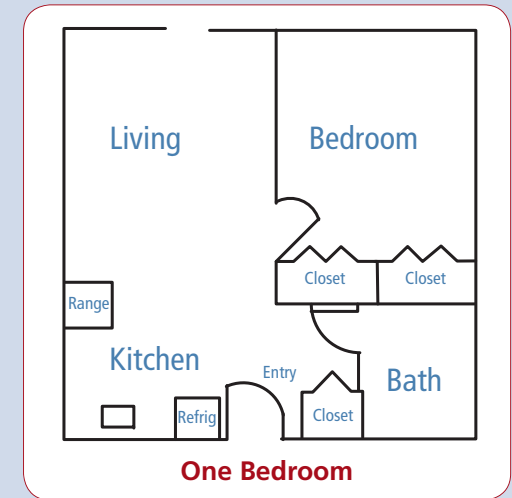

## To Learn More

Emanuel Village, located in Worcester, Massachusetts, is a not-for-profit low-income housing program for individuals who are elderly and/or mobility impaired.

Emanuel Village is a program of Lutheran Social Services (LSS).

Emanuel Village welcomes all applicants regardless of race, color, religion, gender, handicap status, family status or national origin.

To find out more about Emanuel Village, please contact us at:

59 Evelyn Street

Worcester, MA 01607

508.753.7474

508.753.0376 fax

1.800.439.2370 (TTY Relay)

E-mail: [info@emanuelvillage.org](mailto:info@emanuelvillage.org)

[www.lssne.org/emanuel\\_village.html](http://www.lssne.org/emanuel_village.html)

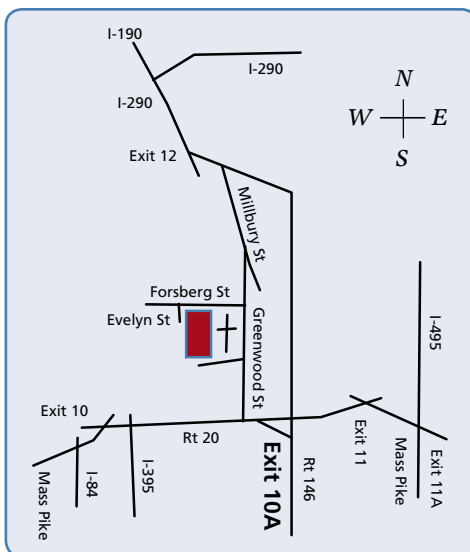

## Call Emanuel Village today!

508.753.7474

[www.lssne.org/emanuel\\_village.html](http://www.lssne.org/emanuel_village.html)

*In response to Christ's love,  
Lutheran Social Services  
Serves and cares for people in need.*

Emanuel Village is a program of Lutheran Social Services (LSS). LSS is one of the largest social service organizations in New England. We combine personalized, compassionate care with high standards of clinical sophistication and operational excellence to deliver a broad variety of services to children, youth and families; persons with developmental disabilities, mental illness and Deafness; the economically disadvantaged; refugees and older adults. In keeping with our mission, we serve and care for people in need, regardless of background or belief.

 Lutheran Social Services

888 Worcester Street, Suite 160

Wellesley, Massachusetts 02482

781.997.0820

781.997.0888 fax

[info@lssne.org](mailto:info@lssne.org)

[www.lssne.org](http://www.lssne.org)

## Emanuel Village

A Program of Lutheran Social Services



## Your New Home Is Waiting!



 Lutheran Social Services